

Ref: TT0013
v1.0

MDR Check Password message

Related Products – Mobile Digital Recorder MDR 500 Series 2nd Generation

Full details of this issue can be found in Section **7.1.4 User Setup** of the current **Installation and Operation Guide**.

After installing a Gen 2 MDR 500 and powering up, the On Screen Display (OSD) will show a message that states the 'current password is too simple'. If the installer decides that the password does not need changing, clicking **No** will stop this message from reappearing. If the installer has clicked **Yes** and then **Exit** on the next page, the message will appear every time the MDR is powered up.

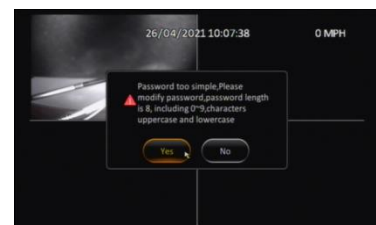

To clear the 'current password is too simple' message after clicking **Yes**, the installer will need to access the **Basic Setup** page on the OSD. Go to **User Setup** and untick the **Check Password** box. Click **Save** and then after the **Saved Successfully!** popup box is visible click **OK**. Power down the MDR to save the settings.



Config Files - If you have saved a Config File, for settings, off a 1st Generation MDR 500 Series and wish to upload onto a 2nd Generation MDR 500 Series, please be aware this will change the **Check Password** to enabled, which will show the 'current password is too simple' message again. Follow the instructions above to disable.

This password verification has been included into our 2nd Generation MDR 500 Series to conform to the UK General Data Protection Regulation (GDPR) requirements.

If a stronger password is required, it must be at least 8 characters long, can include digits 0-9 and characters in both uppercase and lowercase.

